



PERFECT FIT DOUBLE BREAST PUMP



COMPONENTS OF

PERFECT FIT DOUBLE BREAST PUMP

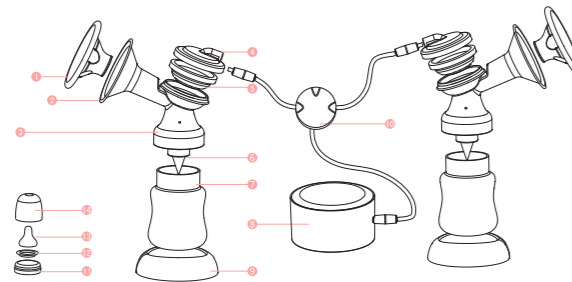

No	Name	Material	Temperature	Quantity
1	Anti-dust Cover	PP	-20~120°C	2
2	Breast Shield	Silicone PP	-20~120°C	2
3	Connector	PP	-20~120°C	2
4	Suction Cylinder Cover	PP	-20~120°C	2
5	Suction Ring	Silicone	-20~120°C	2
6	Valve	Silicone	-20~120°C	4
7	Feeding Bottle	PP	-20~ 90°C	2
8	Pump Motor	ABS	-20~120°C	1
9	Feeding Bottle Base	PP	-20~120°C	2
10	Tube	Silicone	-20~120°C	2
11	Bottle Cap	PP	-20~120°C	2
12	Overflow Cap	PP	-20~120°C	2
13	Nipple	Silicone	-20~120°C	2
14	Bottle Nipple Anti-dust Cover	PP	-20~120°C	2

FUNCTION DESCRIPTION OF

PERFECT FIT DOUBLE BREAST PUMP

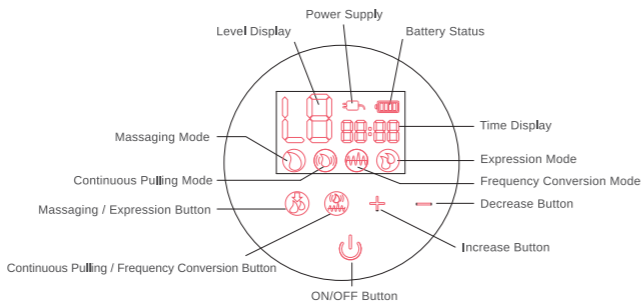

OPERATING INSTRUCTION

- Press On/Off button . When the screen panel is lit up, select mode.
- Massaging Mode:** Press icon until the display shows . It will mimic baby's sucking rhythm. The suction will be small and quick as it helps to massage and stimulate the breast. Adjust to suitable suction power by pressing **+** or **-**. There are 6 levels of adjustment.
- Expression Mode:** Press icon until display shows . It will switch to slow sucking rhythm to express milk. Adjust to the suitable suction power by pressing **+** or **-**. There are 9 levels of adjustment.
- Continuous Pulling Mode:** Press icon until display shows . It will enter into a long pulling suction rhythm, used at the end/final stage of milk expression. Adjust to suitable suction power by pressing **+** or **-**. There are 6 levels of adjustment.
- Frequency Conversion Mode:** Press icon until display show . It will allow user to change the frequency intensity to the desirable level. Adjust to suitable frequency by pressing **+** or **-**. There are 9 levels of adjustment.

FEATURES OF

PERFECT FIT DOUBLE BREAST PUMP

- 4 Phase Expression**
- Full LED Touch Screen**
- Powerful Suction 80-300mmHg**
- Small Size like Smart Phone**
- 9 Level Adjustable**
- Mimic Baby Sucking**
- Super Quiet**
- Memory Function**
- Power Supply by AC, USB or Lithium Ion Battery**
- Large Capacity Lithium Ion Battery**

ISO9001: 2000

TECHNICAL PARAMETERS OF

PERFECT FIT DOUBLE BREAST PUMP

- Power : 5W**
- Voltage : AC110-220V/DC5V**
- Suction Power : 80-300mmHg**
- Suction Control : 9 Levels**
- Expression : 4 Phase**
- Battery : Lithium Ion**
- Warranty : 2 Years**

HOW TO USE

PERFECT FIT DOUBLE BREAST PUMP

- Wash your hands thoroughly before assembling the breast pump parts.
- Breast pump parts (except pump motor and tube) should be cleaned and sterilized in advance. Parts that are not clean or worn out will result in weak or no suction. To convert to single pump, use single tube. For step by step assembly, kindly refer diagram on page How To Assemble.
- Before start pumping, massage your breasts or warm them with a warm towel for few minutes as this will help to produce more milk.
- Fit the breast shield to your breast closely to create a vacuum. Sit down and relax while your upper body slightly lean forward. Turn on the pump and start pumping.
- It is recommended that each pumping session should not be more than 20 minutes. If milk is not flowing out after 5 minutes, kindly stop and choose other time to pump. Should you facing this scenario frequently, please consult a doctor or a lactation specialist.
- The pump motor is designed to stop after 30 minutes of each session for safety reason.

CARE AND CLEANING

- After each pumping session, remove and disassemble all the parts. Wash and sterilize all the parts that were in contact with breast and milk except pump body and tube.
- Wipe the pump motor and tube with damp cloth.
- Do not immerse pump motor and tube into water. Any mishandling will void its warranty.
- For assembling and disassembling, please do in accordance to its assembly sequence. Refer diagram on page How To Assemble.
- Do not leave the pump in operating unattended.

HOW TO ASSEMBLE

PERFECT FIT DOUBLE BREAST PUMP

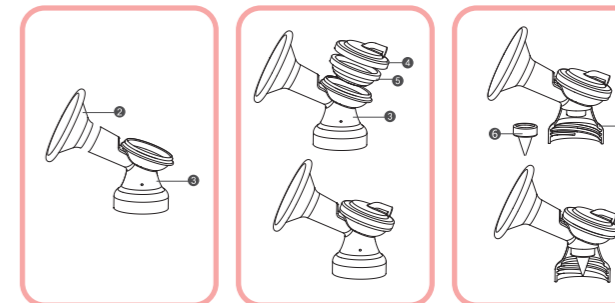

Install Perfect Fit Breastshield Funnel to the connector.

Install the suction ring into breast shield tightly, then press the suction cylinder cover into the breast shield.

Install the valve into the round surface of the breast shield. (Note: Please install it carefully. If found any damage, kindly replace)

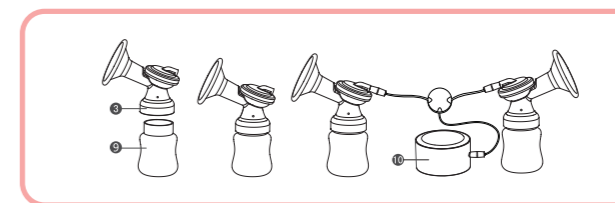

Install the breast shield to the bottle, connect the tube to breast shield and pump motor. Make sure it is secured properly. (Note: Use single tube to convert to single pumping)

WARRANTY CARD

PERFECT FIT DOUBLE BREAST PUMP

BUB 0025



Grato Marketing Sdn Bhd (977624-M)

C-0-3A, Pusat Perdagangan Kuchai,
No 2, Jalan 1/127, Off Jalan Kuchai Lama,
58200 Kuala Lumpur.
Tel: 03-7971 6701 Fax: 03-7982 0042
Website: www.grato.com.my

Limited Warranty Period : **2 years**

Product Name : Bubbles :L9 Perfect Fit Double Breast Pump

Customer Name : _____

Retailer Chop Sign: _____

Date of Purchase: _____

Customer Copy

Warranty Terms & Conditions:

Thank you for purchasing our product. For a period of 2 years from original purchase of this product, Grato Marketing Sdn Bhd warrants this product against manufacturing defects. At Grato marketing Sdn Bhd's option, the company may repair or replace any product that is determined to be defective by the company and determined to be covered by this warranty subjected to the terms and conditions listed below :

- The warranty is applicable for product purchased through authorized seller only.
- This warranty card is non-transferable.
- The warranty is only cover against manufacturing defects. The warranty applies only to defect which occur under conditions of normal usage within the warranty period. It does not extend beyond defect arising from abuse, faulty care or maintenance.
- The warranty does not cover negligent utilization, mishandling, or tampering of the product by the customer. Company will also not be responsible for damage of product through natural disasters.
- The warranty does not cover component parts which require replacement in the ordinary course of use due to normal wear and tear by reason of their characteristics, including accessories.
- The warranty does not cover unauthorized change, modification or extend the terms of these warranties in any manner.
- Warranty is valid from the date of purchase and period as stated.