

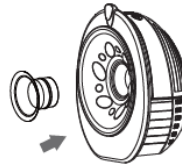

BUB0029

### 1. Features

- Special design -Can pump while lying down
- 3 modes  
Massage & Stimulation & Expression . 9 levels Adjustable.
- Handsfree  
Wear it under your bra and keep hands free.
- Anti-backflow Function  
The professional backflow protection system prevents the milk from getting into the Pump motor, and keeps the milk clean.
- Auto shut off in 30 minutes
- Additional funnel inserts fit for various nipple sizes  
(Optional to use)



Choose a funnel insert according to your nipple size, and then push the funnel insert into the Breast shield. (Optional to use)

### 2. Specifications

Level	9	Max. suction power	≥270mmHg
Usage time	≈30 minutes/time	Working condition	5-40°C
Adapter output	5V ==1A		

### 3. Component parts

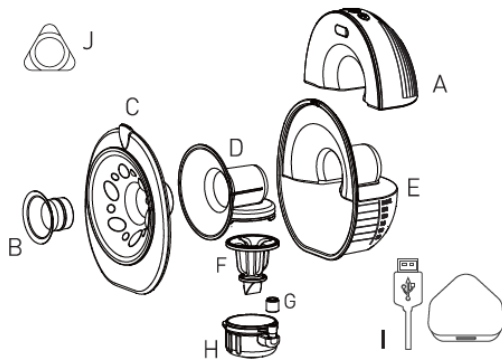

No.	Item	Material	Heat-resisting temperature
A	Pump motor	/	/
B	Funnel insert	Silicone	120°C
C	Silicone Braast shield	Silicone	120°C
D	Linker	PP	120°C
E	Milk collector	PP	120°C
F	Suction valve	Silicone	120°C
D	Sealed ring	Silicone	120°C
H	Holder	PP	120°C
I	Type-C USB cable & Plug	/	/
J	Triangular tool	/	/

### 4. Installation

**! Before assembly, please make sure all parts are dried**

1. Install the suction valve into the holder.
2. Push the sealed ring all the way down to the holder.
3. Make sure they seal with holder flatly
4. Make sure this valve through the hole of holder, and the circle of valve should be under the holder.

4.Installation

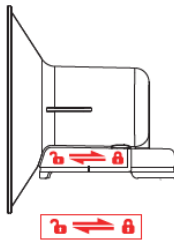

5. Search the unlock and lock icon

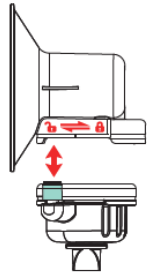

6. Align the green sealed ring to the unlock position

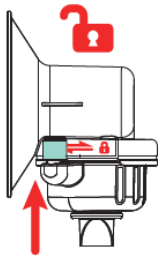

7. Push the holder to the linker (in unlock position)

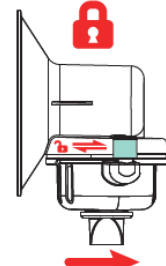

8. Rotate to the right side, it reaches the lock position, till wouldn't be rotate anymore.

4.Installation

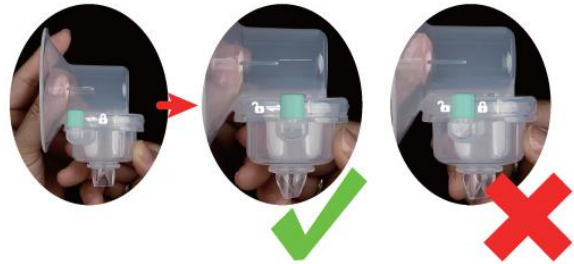

Unlock → Rotate to right side → Lock

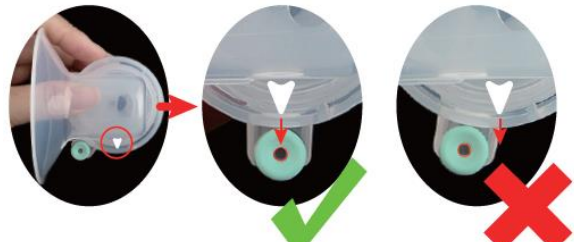

Unlock → Rotate to right side → Lock

4.Installation

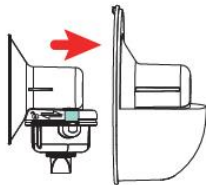

9. Push the linker all the way down to the milk collector. Ensure the flange of linker stick closely to milk collector as picture shown.

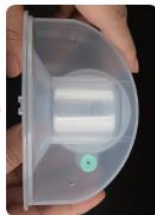
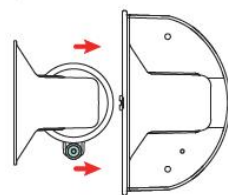
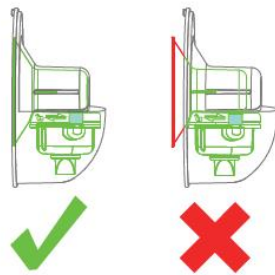

10. Please make sure both of the holes are aligned as picture shown.

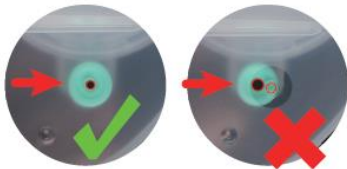

4.Installation

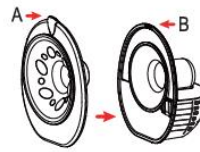

11. Install the breast shield to milk collector.

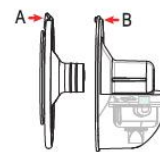

12. Make sure the pouring spout(A) to the milk collector(B), they must align, otherwise there will be leakage.



13. Press the center of breast shield, make it stuck in linker lightly.

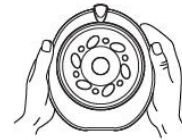

14. Press the edges of breast shield around, make it seal well with milk collector.



#### 4. Installation



15. Push the pump motor to the milk collector.

16. Done.

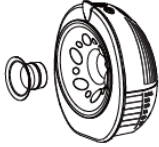

17. Install the funnel insert to breast shield. (Choose one of funnel insert according to your nipple size. This is spare part, you can use it or not for these spare part).

#### 5. How to wear the breast pump?

Attach breast shield to your breast closely and guide your nipple to the center of the funnel. Adjust your nursing bra accordingly to your comfort.

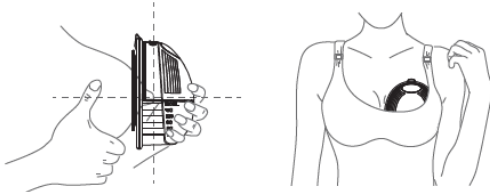

Mothers can pump while sitting, standing, walking or lying down.

#### 6. Operational instructions



1. Press **⏻** for 2 seconds to turn on, it show "88". After 1 second, it start to massage mode and show level then timer.



2. Press **⏻** switch to Express mode.



3. Press **⏻** switch to stimulation mode.

Press **⏻** for 2 seconds to turn it off after you finish pumping.

#### 7. Usage

1. Please Charge the breast pump before using it for the first time. (For safety reason, the breast pump cannot be turned on during charging.)
2. Please wait for about 180 minutes to get it fully charged while the power is low.
3. Adapter output Requirement: 5V == 1A.
4. Please make sure your mammary gland is not blocked and massage your breast with a hot towel.
5. Please clean the breast and nipples.
6. Please massage the breast gently before start pumping.
7. Press **⏻** to turn on, the breast pump enter to massage mode first, and it will automatically switch to expression after 2 minutes.
8. When the milk going to flow, please switch to expression mode or stimulation mode by press **⏻**.

#### 5. How to wear the breast pump?



When lying down at angle of 135°, the maximum capacity is 180mL.



When lying down at angle of 150°, the maximum capacity is 120mL.

#### 6. Operational instructions

**⏻** On/Off: Press for 2 seconds  
**⏻** Mode switch button: Press for 1 second

Total 3 modes for this breast pump

1. Massage mode as shown
2. Expression mode as shown
3. Stimulation mode (massage and expression at the same time), as shown.

**⏻** Level up button: (Maximum level 9)

**⏻** Level down button: (Minimum level 1)



Level



Timer



1.

Massage



2.

Expression

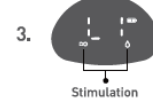

3.

Stimulation

#### 8. Ready to pour breast milk



1. Remove the breast pump from your breast, if there is remaining milk in the holder or funnel, please let it get into milk collector, then turn off.

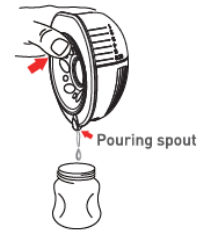

2. Squeezing the bottom of the breast pump repeatedly to pour, pour the milk into the feeding bottle or milk storage bag.

#### How to remove motor?

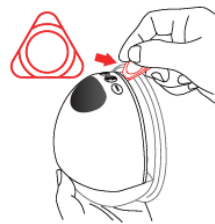

1. Pry it open with the triangular tool.

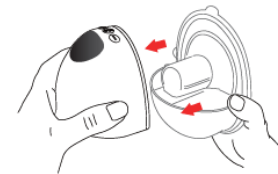

2. Pull it out as shown.

## 9. Trouble shooting

• Any problems please take the following solution.

problem	reason	solution
Weak suction	1. Component got wet.	1. Dry out all parts.
	2. The valve was damaged or not install properly.	2. Replace a new one or re-install it.
	3. Accessories did not connect well.	3. Check all the connection parts and re-assemble them.
	4. The silicone breast shield did not seal well with milk collector.	4. Please re-assemble the silicone breast shield, make sure there are no gap between breast shield and milk collector.
	5. The breast shield was not attached to the breast closely.	5. Make sure the breast shield is attached to the breast closely.
No suction	Please don't use sharp tool to wash the suction valve, there is no suction or weak suction if it was damaged	
	1. No valve, or the valve damaged.	1 Don't forget to install the valve, if the valve damaged, please replace a new one.
	2. Install the valve wrongly.	2. The suction valve must be through holder as installation step 3 & 4
	3. Install the holder wrongly.	3. Please install the holder to linker correctly as installation step 6 & 7 & 8
Cannot Switch on	1. The battery ran out of power.	1. Please take for about 180 minutes to get the battery fully charged.
Leakage	1&2&3, Leakage of milk collector,	1. Please double check the valve&holder&linker &breast shield, make sure they are installed correctly. 2. During pump, keep the pouring spout upward, and the breast milk don't over 180ml. 3. When lying down, the horizontal line of breast milk should not exceed the pouring spout.

## 10. Disinfection



**Make sure disassemble all accessories of milk collector before disinfection, otherwise the silicone accessories will be deformed, it might cause weak suction.**

<b>Steam</b> Use a steam bottle sterilizer to disinfect, which is safe, avoiding the deformation of the accessories	
<b>Microwave</b> Please put the spare parts into a water container and then into the microwave, and please follow the microwave instructions book..	
<b>Boiling</b> Put the parts into water and boil for 5 minutes and take them out	
Do not use dry heater, or dryer to disinfect Do not put in dishwasher to clean it	

• Note: The Pump motor cannot be washed or disinfected.  
 Dry all parts in the air thoroughly after disinfection. When using the disinfection equipment, be sure to follow the manufacturer's instructions.